

**** Table Of Content/目录 ****

1. SCOPE.....	3
1.1. Description.....	3
2. Input Characteristics/输入特性.....	3
2.1. Input Voltage & Frequency/输入电压与频率.....	3
2.2. Input AC Current/AC 输入电流.....	3
2.3. Inrush Current (cold start)/浪涌电流(冷启动).....	3
2.4. Average Efficiency 平均效率.....	3
2.5. Energy Consumption /空载功耗.....	3
3. Output Characteristics/输出特性.....	3
3.1. Static Output Characteristics <Vo & R+N>/静态输出特性.....	3
3.3. Turn - on Delay Time/开机延迟时间.....	4
3.4. Hold-up Time/关机维持时间.....	4
3.5. Rise Time/上升时间.....	4
3.6. Fall Time/下降时间.....	4
3.7. Output Overshoot / Undershoot/输出过冲/欠冲.....	4
4. Protection Requirements/保护要求.....	4
4.1. Over Current Protection/过流保护.....	4
4.2. Short Circuit Protection/短路保护.....	5
5. Environment Requirements/环境要求.....	5
5.1. Operating Temperature and Relative Humidity/操作温/湿度要求.....	5
5.2. Storage Temperature and Relative Humidity/存储温/湿度要求.....	5
5.3. Vibration/振动.....	5
5.4. Drop in/跌落.....	5
6. Reliability Requirements/可靠性要求.....	5
6.1. Burn-in/煲机.....	5
7. EMI/EMS Standards/EMI/EMS 标准.....	5
7.1. EMI Standards/EMI 标准.....	5
7.2. EMS Standards/EMS 标准.....	5
8. Safety Standards/安规标准.....	7
8.1. Dielectric Strength(Hi-pot)/介电耐压强度(高压).....	7
8.2. Leakage Current/漏电流.....	7
8.3. Insulation Resistance/绝缘阻抗.....	7
8.4. Regulatory Standards/安规标准.....	7
9. Match. Outline Drawing/外观示意图.....	8
10. I/O Marking Drawing/铭牌示意图.....	9
11. Package Drawing/包装示意图.....	9

① Smart IC for optional

智能可选项：

 无智能识别功能，无单口过流保护功能。

Without Auto detect function, Without each port ocp function

 有智能识别功能，无单口过流保护功能。

With Auto detect function, Without each port ocp function

 有智能识别功能，有单口过流保护功能。

With Auto detect function, With Each Port OCP function

②所谓智能识别功能：是指通电后，该电源能自动识别终端设备为平板或手机，并提供该设备所需要的最大充电电流。

Auto detect means when device connect with charger, it can automatically recognize the device, such as tablet pc or mobile phone, then it output the max current for the device.

③所谓单口过流保护功能：是指当某种原因导致输出短路或，被测负载电流超过预定值的上限时，该端口单口保护，无输出电压，当故障去除后，可自动恢复。

Each port ocp function means when faults lead to short circuit or loading exceed the definition current, the fault port will be protected and no voltage output, when fault remove, it will automatically recover.

3. Ripple & Noise: Measurement is done by 20MHz bandwidth oscilloscope and the output paralleled a 0.1uF ceramic capacitor and a 10uF electrolysis capacitor. (test under the condition of rated input and rated output)

③.纹波与噪声：量测时示波器选用 **20MHz** 带宽限制，输出端要并联一颗 **0.1uF** 的陶瓷电容和一颗 **10uF** 的电解电容。（在额定输入及输出的条件下检测）

3.2. Turn - on Delay Time/开机延迟时间

3S max. @ 100Vac to 240Vac input & Full load/满载

3.3. Hold-up Time/关机维持时间

10mS min. @ Full load & 115Vac/60Hz input turn off at worst case/在最差情况关机

20mS min. @ Full load & 230Vac/50Hz input turn off at worst case/在最差情况关机

3.4. Rise Time/上升时间

20mS max. @ Rated load/额定负载

3.5. Fall Time/下降时间

20mS max. @ Full load/满载

3.6. Output Overshoot / Undershoot/输出过冲/欠冲

10% max. When the power on or off/当电源开/关机时

4. Protection Requirements/保护要求**4.1. Over Current Protection/过流保护**

When Loading exceed 110-150% of rated current, OCP function will Start up, usb charger enter hiccup mode, ocp situation solved, product will automatically recover to work .

当负载电流超过额定电流的 110-150% 时输出过流保护，电源进入打嗝模式，过流情况解除后，产品将会自动恢复正常

4.2 Short Circuit Protection/短路保护

When output occur short circuit,usb charger enter hiccup mode,when ocp situation solved,product will automatically recover to work .

当输出短路时,电源自动保护,进入打嗝模式,当短路情况解除后,产品将会自动恢复正常

5. Environment Requirements/环境要求

5.1. Operating Temperature and Relative Humidity/操作温/湿度要求

0°C to +40°C

10%RH to 90%RH

5.2. Storage Temperature and Relative Humidity/存储温/湿度要求

-20°C to +80°C

5%RH to 95%RH non-condensing @ Sea level shall be low 2,000 meter/低于 2,000 米.

5.3. Vibration/振动

10 to 300Hz sweep at a constant acceleration of 1.0G(Breadth: 3.5mm) for 1Hour for each of the perpendicular axes X, Y, Z

扫描频率: 10 to 300Hz, 加速度: 1.0G(位移: 3.5mm), X, Y, Z 三垂直坐标轴向各振动 1 小时

5.4. Drop in/跌落

Height: 1m; the product should be fell off on the hardwood with the thickness of 20mm, and the hardwood should be put on the base of the cement or on the ground without flexibility. Apply two times on all surface. Apply two times on all corner.

跌落高度:1 米, 并跌落到厚度为 20mm 的硬木上, 且硬木应放在水泥基座或等同的无弹性地面上, 每面各 2 次, 每角各 2 次。

6. Reliability Requirements/可靠性要求

6.1. Burn-in/煲机

The power supply shall be burn-in for 4 Hours under normal input and 80% rated load at 40°C ± 5°C

产品至少要在 40°C ± 5°C 的环境及 80% 额定负载条件下煲机 4 小时

7. EMI/EMS Standards/EMI/EMS 标准

7.1. EMI Standards/EMI 标准

EN 55022

FCC Part 15 Subpart B

7.2. EMS Standards/EMS 标准

7-2-1 EN 61000-4-2,electrostatic discharge(ESD) requirement/静电抗扰度要求

Discharge characteristic/静电规格	Test level/测试条件	Test criteria/测试标准
Air discharge/空气放电	+/-8KV	B
Contact discharge/接触放电	+/-6KV	B

7-2-2 EN 61000-4-3, radiated electromagnetic field susceptibility(rs)/辐射骚扰场强

Test level/测试条件	Test criteria/测试标准
3V/m (r.m.s)	A
80-1000MHz, 80%AM(1KHz) sine-wave	

7-2-3 EN 61000-4-4, electric fast transients(burst) immunity requirement/电快速瞬变脉冲群

Coupling/测试端口	Test level/测试条件	Test criteria/测试标准
AC-input/交流输入	0.5KV	A
AC-input/交流输入	1KV	B

7-2-4 EN 61000-4-5, surge capability requirement/浪涌抗扰度要求

Surge voltage/雷击电压	Test criteria/测试标准
Common mode/共模 +/-2KV	A
Differential mode/差模 +/-1KV	

7-2-5 EN 61000-4-6, Induced radio frequency fields conducted disturbances immunity requirement/电源端子传导骚扰实验

Test level/测试条件	Test criteria/测试标准
3V	A
0.15-80 MHz, 80%AM(1KHz)	

7-2-6 Assessment criteria /评估标准

Acceptance criteria 可接受标准	Performance 性能
A	Agreed operational behavior within the specified limits 性能不允许变化；如果性能会发生变化，则变化的范围在产品规格书规定的范围内。
B	Time limited functional diminishment or malfunction during the tests is permitted. The function is self-reactivated by the unit following completion of the tests. 设备在测试过程中, 性能降低允许在产品规格书要求范围内, 干扰消除后, 设备能恢复正常, 不允许出现复位和任何方式的人工干预。
C	Malfunction is permitted .The function can be reactivated either by reconnection to the mains or by operator intervention. 在测试过程中, 设备允许出现业务中断, 测试完毕后允许自行恢复或者人工干预恢复（包括硬件上干预）；测试中只允许初级防护器件损坏, 并且更换损坏的初级防护器件后, 设备能恢复正常

8. Safety Standards/安规标准

8.1. Dielectric Strength(Hi-pot)/介电耐压强度(高压)

Primary to Secondary: 3000Vac / 5mA Max / 60 second

初级对次级: **3000Vac / 5mA Max / 60 秒**

8.2. Leakage Current/漏电流

0.25mA max. at 264Vac / 50Hz

8.3. Insulation Resistance/绝缘阻抗

50MΩ min. at primary to secondary add 500Vdc test voltage

在初级与次级间加 **500Vdc** 进行测试

8.4. Regulatory Standards/安规标准

Type/安规	Country/国家	Standard/标准	State/状况	Note/备注
CE	Europe	EN 60950-1	已认证	

9. Match. Outline Drawing/外观示意图

欧规 2USB 5V 3.4A 插墙式 (白色外壳)

USB plug 2USB 5V 3.4A wall mount (White House)

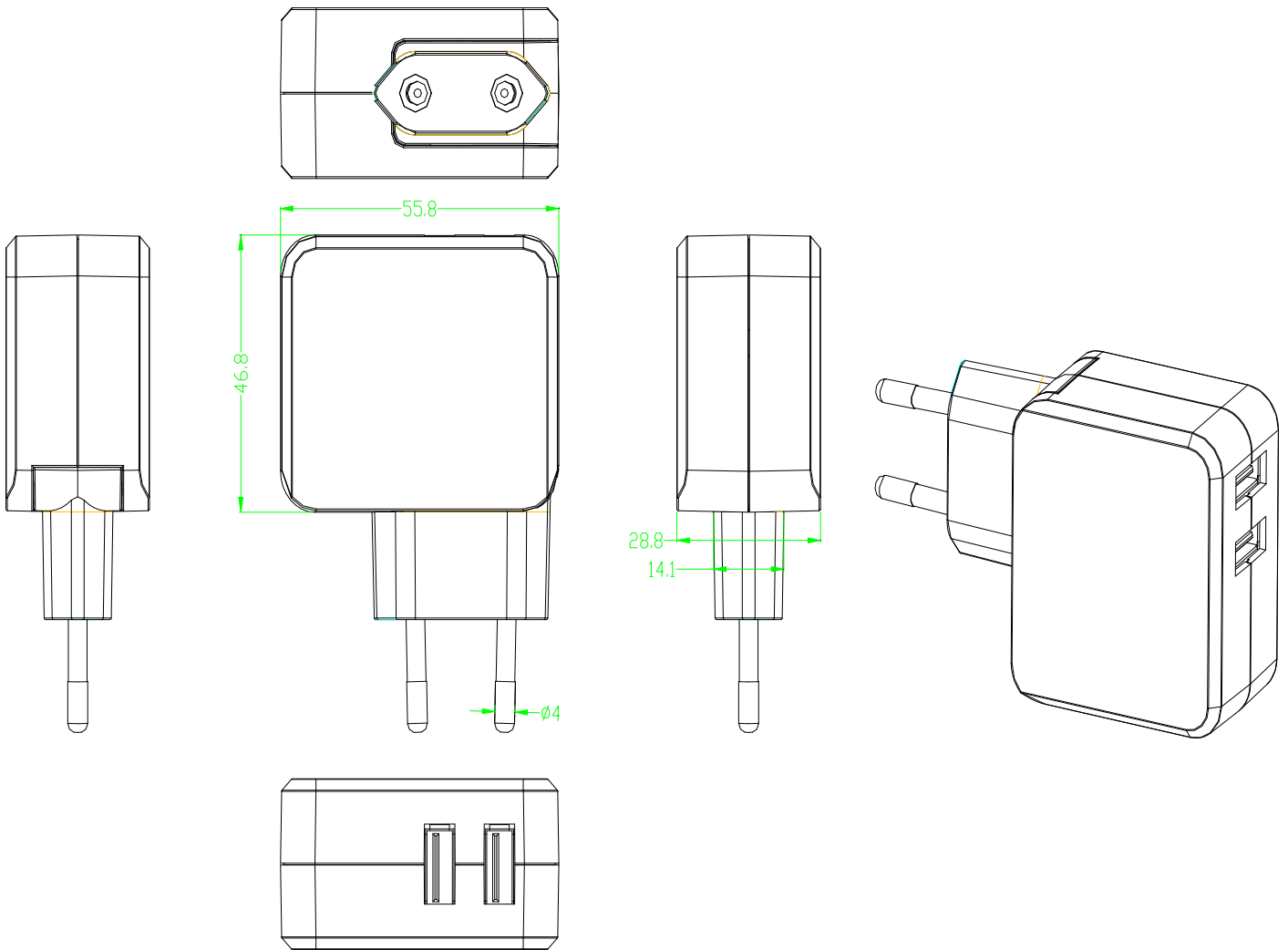

外壳材质/ shell materia: ■PC 耐温: 120°C/ temperature resistance 120°C

□PC+ABS 耐温: 95°C/ temperature resistance 95°C

备注: PC 材质符合球压测试要求/ remark: PC texture

10. I/O Marking Drawing/丝印或镭雕示意图

注：丝印或镭雕图档

30

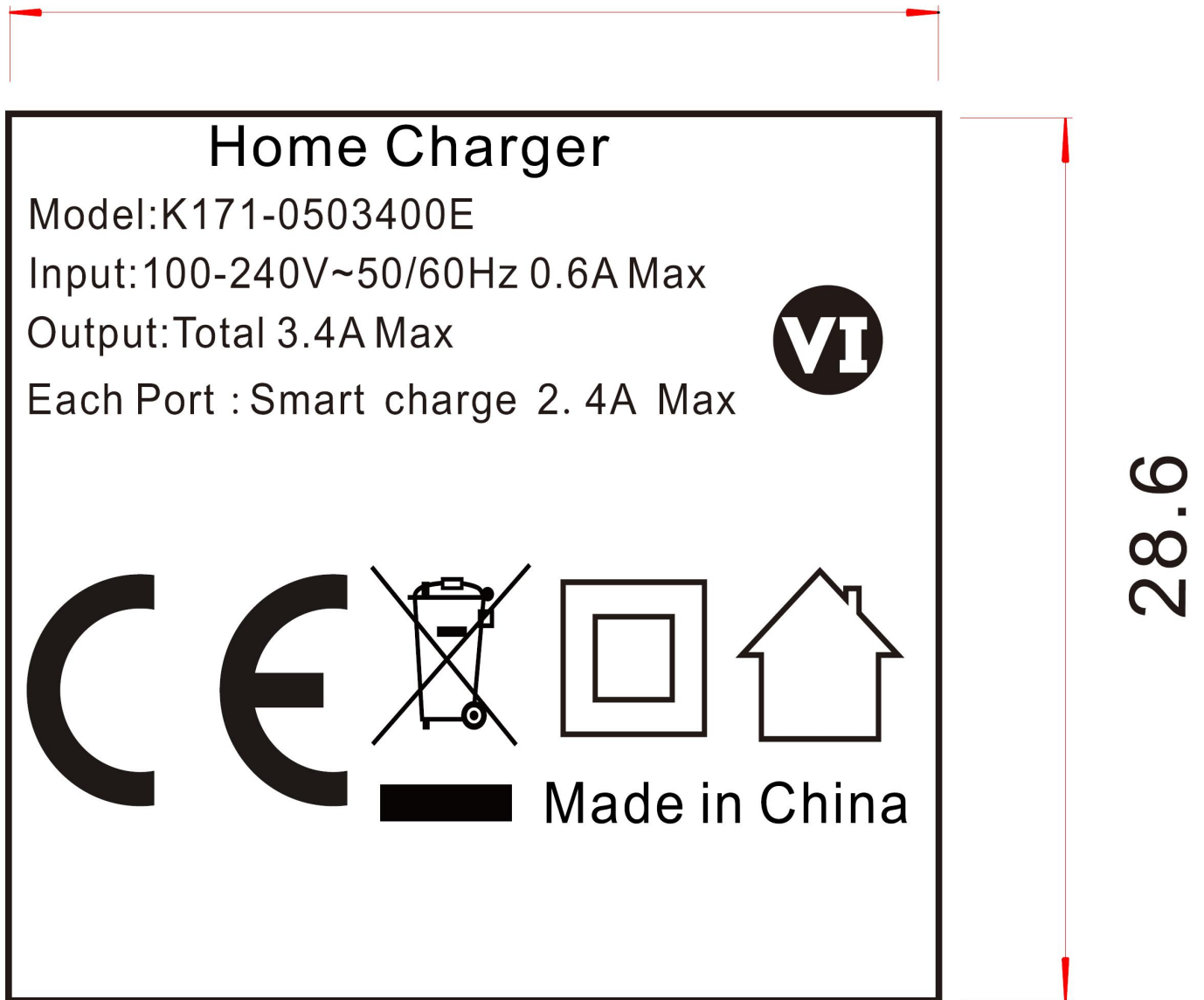

11. Package Drawing/包装示意图

	变更说明	日期

汽泡袋
料号: 35B-1201550-000
尺寸: 120*155+10mm

隔板
料号: 36D-4553500-000
尺寸: 455*350*3mm
用量: 5PCS

7刀卡
料号: 36E-4570410-000
尺寸: 长457*高41MM
用量: 12PCS

3刀卡
料号: 36E-3520410-000
尺寸: 长352*高41MM
用量: 28PCS

外箱
料号: 36C-4703650-000
尺寸: 470*365*190mm
唛头: 丝印在纸箱正面和侧面中间, 印4面, 印法如上图
用量: 一箱分4层, 一箱128PCS, 一层32PCS

深圳市澳博森科技有限公司				
部品名称	外箱+刀卡	图号		
适用机种	K171	作图	何雨欣	
单位: mm	比例:	日期	2016. 09. 22	
数量:	版本:A/0	外箱料号	36C-4703650-000	